

VISTA DA "A"

dB-killer  $\varnothing 38$   
n.52 Cod.308421801

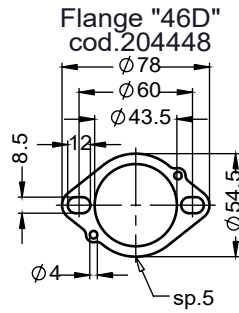

VISTA "B"

Flange "46D"  
cod.204448

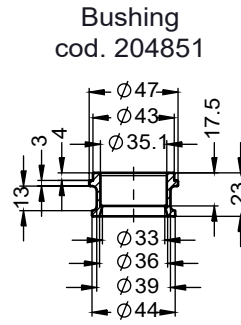

Bushing  
cod. 204851

VISTA DA "C"

compensating tubes  
- Inside hole  $\varnothing 12\text{mm}$

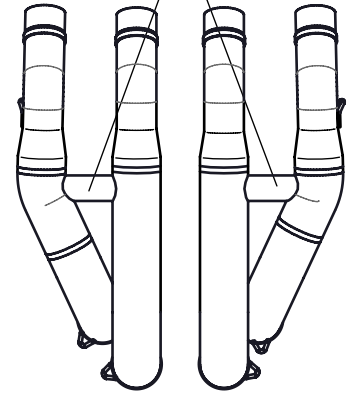

RIDER'S R.H. FOOTBOARD

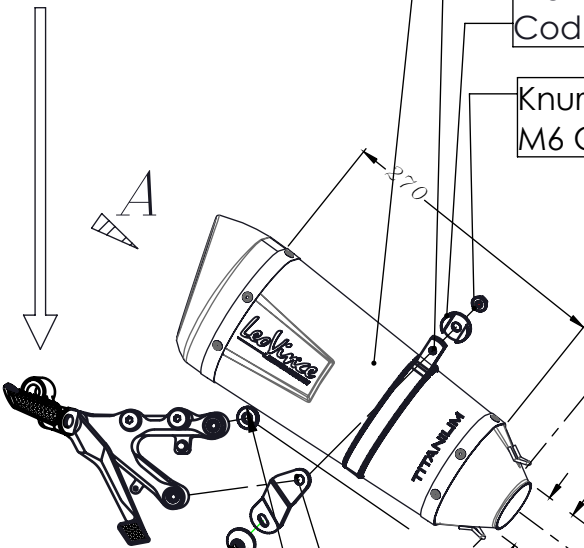

FACTORY S TITANIUM  
 $\varnothing i 54 \times 270$  RHS  
Cod.3014337491U

Carbon clamp FR2  
cod.308448501

Aluminium spacer  
Cod. 205771

Knurled collar nut  
M6 Cod.200333

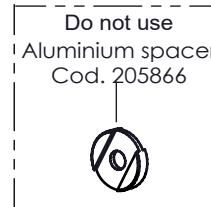

Do not use  
Aluminium spacer  
Cod. 205866

Part supplied in a pack. It has to be used only in motorcycles not equipped with lambda sensor:  
Plug M18x1.5 h.9 cod.201029

Gasket  $\varnothing 18$   
Cod. 202185

Pipe 2/1 s.s  
cod. 308482201

Pipe 2/1 LHS s.s  
cod. 308482203

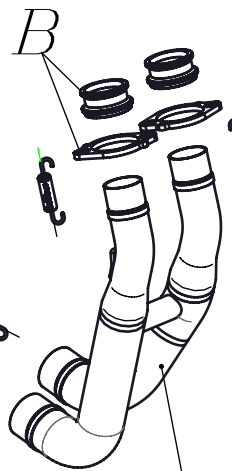

Header pipes LHS  
cod. 308241201

12x Short helical  
spring tensile  
cod. 303949001

Header pipes RHS  
cod. 308241202

Allen screw M6X25  
T.C.E.I.Z.B.  
Cod.200586

Aluminium spacer  
 $\varnothing 27 \times \varnothing 6.5$   
Cod. 205767

Aluminium spacer  
 $\varnothing 20 \times \varnothing 8.5 \times 3$   
Cod. 204785

Bracket S.s  
Prod. cod.088482001  
Purch cod.205864

Pipe 2/1 RHS s.s  
cod. 308482204

# ART. 8483STNU

YAMAHA YZF - R6

FULL SYSTEM 4/2/1 - FACTORY - TITANIUM LIMITED EDITION

By-packed components to be used only on motorcycles not provided with Lambda Probe:  
2x Plug M12x1.25 (cod.204052)  
2x Gasket  $\varnothing 12.3$  (cod.204091)