

STOCK SILENCER

or

LeoVince SILENCERS ART. 8448-8449_8746-8747

14306E-14307E-15233-15233B-15233T

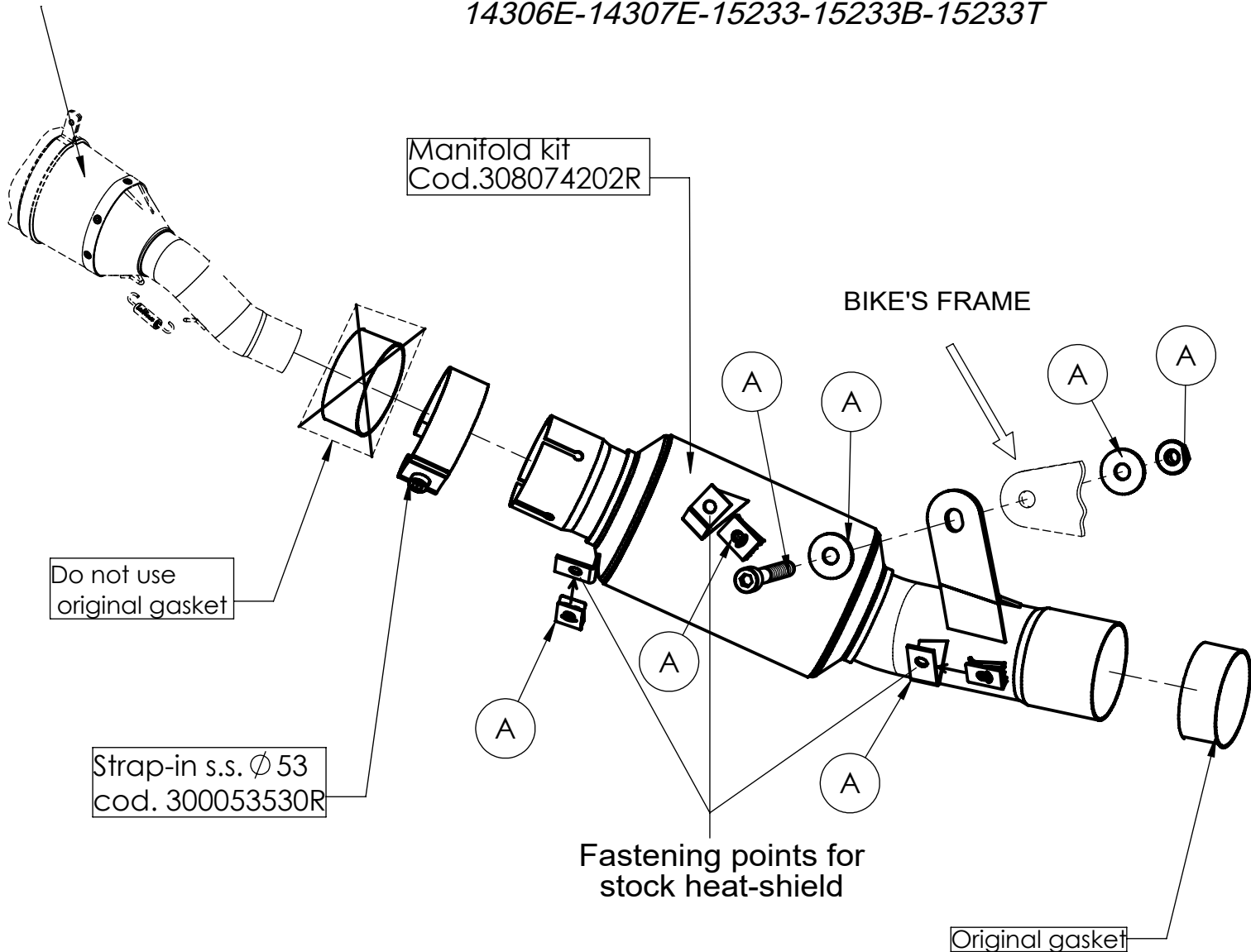

- Disconnect the control cables from the exhaust valve on the actuator side;
by removing the original link pipe with the catalytic converter,
also the valve connected to the link pipe and the cables are removed.
The valve's servo motor should not be removed or disconnected.

ART.8074 SPARE PARTS

KAWASAKI ZX-6R NINJA / KAWASAKI ZX-6R 636 NINJA .

LINK PIPE (*Pre-silencer delete pipe, original catalyst is maintained)
Stainless steel

(A) FITTING KIT Cod. 308074601R