

Extra nuts to be used with original bolts that mount the original exhaust hanger bracket. This will allow you to remove the original hanger bracket but re-use the bolts as to not leave empty holes once the bracket is removed.

S.s end cup set
cod.309746701R

Muffler kit
Cod.3015201483R

Outer sleeve
replacement kit
cod.0815200008R

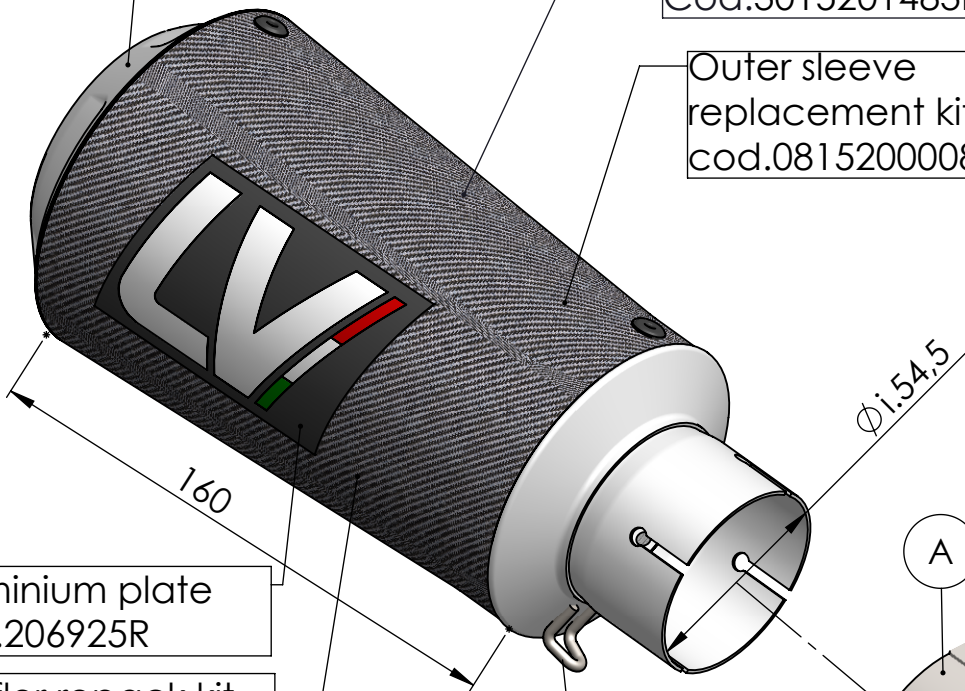
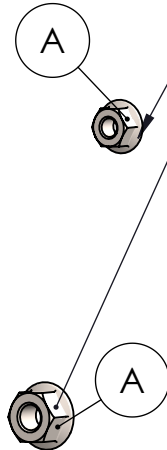

Manifold clamp
Cod.300057530R

Aluminium plate
cod.206925R

Muffler repack kit
cod.414204R

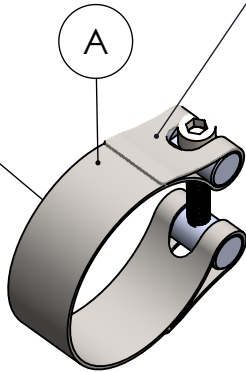

Spring and rubber
replacement kit
Cod.308574001R

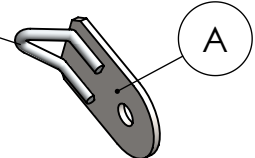
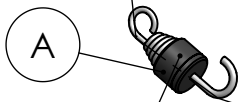

ART. 15203C SPARE PARTS

YAMAHA MT-10/SP

(A) FITTING KIT cod.3015203601R